

**DAILY JOURNAL OF COMMERCE**  
*Helping Business do Business Since 1893*

August 20, 2012

## New zoo exhibit for otters

By [JOURNAL STAFF](#)

Construction is slated to begin in the fall on an exhibit for Asian small-clawed otters and a children's play area at Woodland Park Zoo.

The zoo is seeking bids by Aug. 30 from contractors to build the project, according to a notice in the Aug. 1 DJC.

Construction is expected to cost \$2.4 million.

The project will open next summer.

The otter exhibit will have a 250-square-foot back-of-the-house holding facility for the animals, a 7,000-gallon exhibit pool, life support systems for the otters, wetland area, acrylic viewing panels and viewing areas.

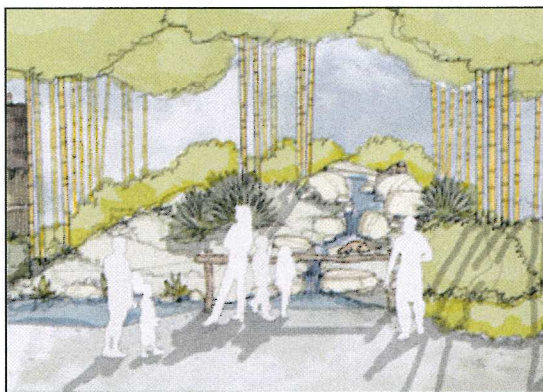

Rendering courtesy of Studio Hanson/Roberts [\[enlarge\]](#)

The play area will have a wobble bridge, mini-zipline, bamboo forest of poles, bamboo scramble, stump hop, puddle boulders, log balance, vine walk, adventure pathway boardwalk and wobble walk bridge.

The project is part of what the zoo is calling the Asian Tropical Forest. The second phase of the complex will have exhibits for sloth bears and Malayan tigers that will be three times the size of the current exhibits built in the 1950s.

Both phases are expected to cost a total of \$19.6 million. The zoo said it still needs to raise \$11 million before it can build the second phase.

The designer is Studio Hanson/Roberts. Other team members are ORB Architects, architect; Turnstone Construction, artificial rockwork; Mette Hanson, artist and naturalist; SvR Design Co., civil; MLA Engineering, structural; CDi Engineers, mechanical; Sparling, electrical; T.A. Maranda Consultants, water filtration; and Natural Systems International, bio-filtration.

---

Copyright 2012 Seattle Daily Journal of Commerce